

SHORE DRIVE, GOODMAN, WI, 54125

https://www.adashunjones.com

SHORE Drive,
GOODMAN, WI,
54125

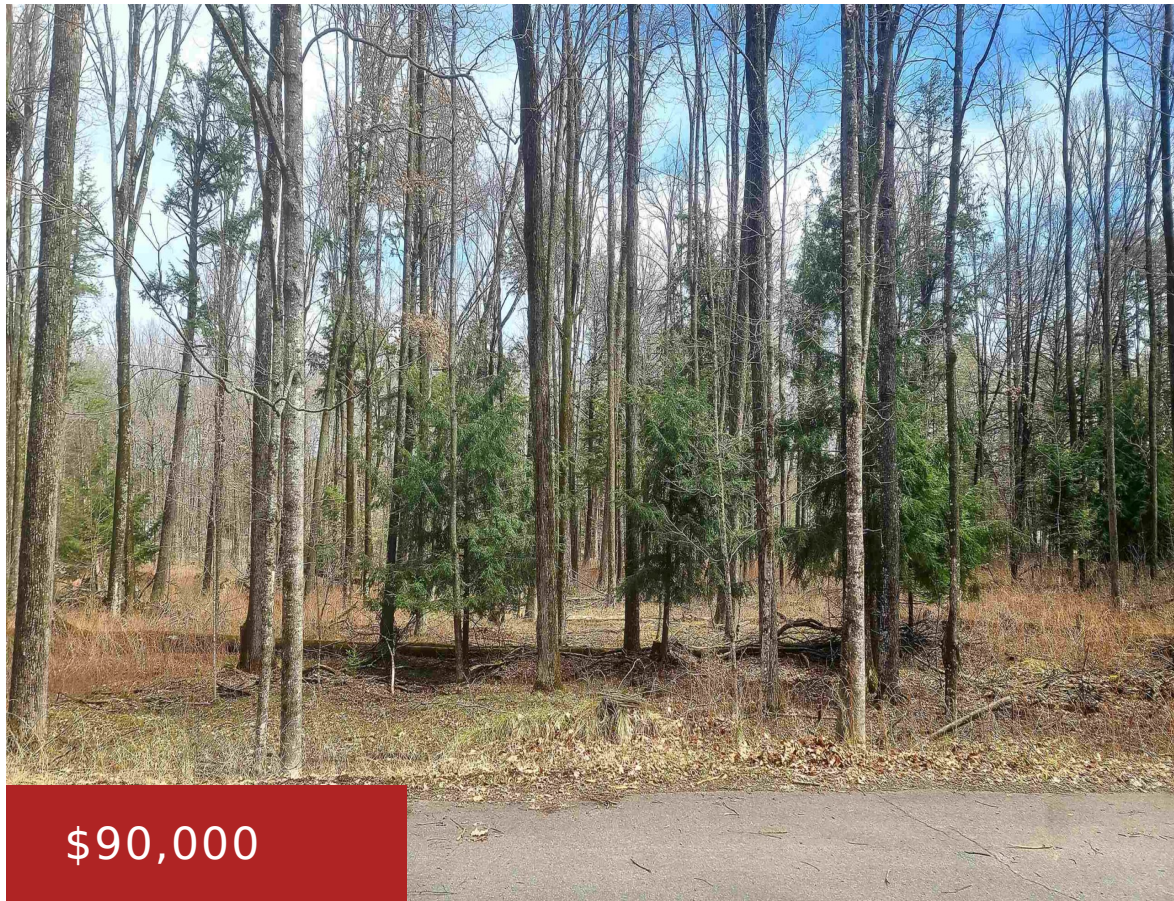

This 3+ acre vacant lot is across the street and has access to Lake Hilbert a 32 ft 278 acre full rec lake, with excellent fishing. Atv/Snowmoblie direct access from property. There is a county park with beach area and a public launch. Come camp or build your dream home. Property is made up of...

- Land
- Residential,Vacant Land/Acreage
- Active



Amanda
Coldwell Banker Real Estate Group

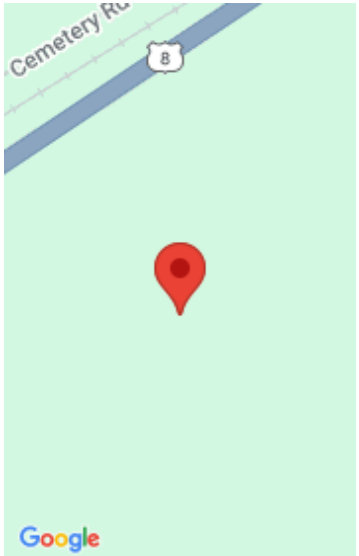

Features

GarageYN: No

FireplaceYN: No

Lot Features: Level, Rural - Not Subdivision, Wooded

Tax Amount: 667.59

AttachedGarageYN: No

PoolPrivateYN: No

Utilities: None

Amenities

Waterfront available: No

Sewer: None

Water Source: None

Building Details

NewConstructionYN: No

Agent Details

Agent Full Name: Amanda Fleischman

Agent Email: afleischman@coldwellhomes.com