

3816 SHORE CREST LANE, GREEN BAY, WI,
54311-9147

https://www.adashunjones.com

3816 SHORE CREST
Lane, GREEN BAY,
WI, 54311-9147

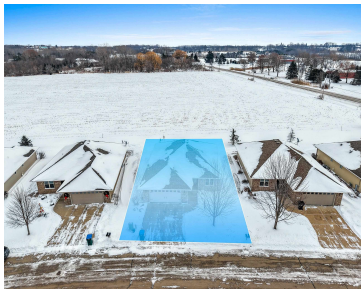

Check out this free-standing condo that features an open-concept main level with gleaming hardwood floors throughout the dining area and kitchen. The kitchen features an island, ample cabinets, kitchen appliances, and a walk-in pantry. The great room, located off the dining area, features a large picture window that looks out onto a private backyard setting....

- 2 beds
- 2 baths
- Residential
- Condominium, Residential
- Active
- 1629 sq ft



Russell
Coldwell Banker Real Estate Group

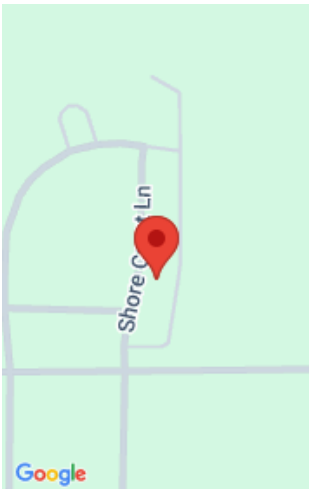

Features

GarageYN: No

FireplaceYN: No

Features: At Least 1 Bathtub,Hi-Speed Internet Availbl,Kitchen Island,None,Pantry,Water Softener-Own/Inc,Wood/Simulated Wood Fl

Tax Amount: 3531

Exclusions: Washer, dryer

AttachedGarageYN: No

PoolPrivateYN: No

Above Grade Finished Area, sq ft: 1629

Inclusions: Range, refrigerator, microwave, dishwasher

Amenities

Waterfront available: No

Cooling: Central Air

Amenities: Dishwasher,Disposal,Microwave,Range,Refrigerator

Water Source: Public

Sewer: Public Sewer

Room Sizes

Room type	Dimensions	Level
Bedroom 1	12x15	Main
Bedroom 2	11x11	Main
Kitchen	23x14	Main
Living Room	13x17	Main
Other Room	11x15	Main

Building Details

NewConstructionYN: No	Heating: Forced Air
Exterior material: Brick,Vinyl Siding	Parking: Attached,Garage,Garage Door Opener

Agent Details

Agent Full Name: Russell J Schisel	Agent Email: rschisel@coldwellhomes.com
---	--