

**LOT 2 CSM 4758 GERRY WAY, DARIEN, WI, 53114-0000**

<https://www.adashunjones.com>

Lot 2 CSM 4758  
Gerry Way, Darien,  
WI, 53114-0000

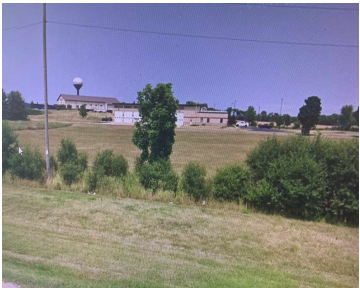

Are you in the market to purchase commercial land to start up your new business? This 3 acre parcel is just what you need. Conveniently located just off Interstate 43 and Highway 14 in the village of Darien. Call today to take a look at the great spot to start building your dreams.

- Commercial/Industrial
- Active



**Barry Rowe**  
Potterton Rule Real Estate LLC

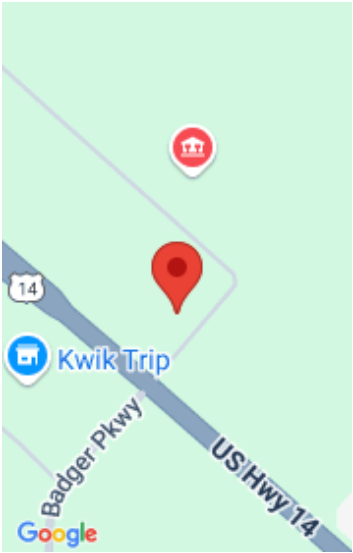

---

# Features

**GarageYN:** No **AttachedGarageYN:** No  
**FireplaceYN:** No **PoolPrivateYN:** No  
**Utilities:** Natural Gas Available, Electricity Available, Phone Available **Tax Year:** 2023  
**Tax Amount:** 1924

---

# Amenities

**Waterfront available:** No **Water Source:** Municipal water available  
**Sewer:** Public Sewer

---

# Building Details

**NewConstructionYN:** No

---

# Agent Details

**Agent Full Name:** Barry Rowe **Agent Email:** BRowe@PottertonRule.com