

**L28 STEPHANIE CIRCLE, PRAIRIE DU CHIEN, WI,
53821-0000**

<https://www.adashunjones.com>

L28 Stephanie
Circle, Prairie Du
Chien, WI,
53821-0000

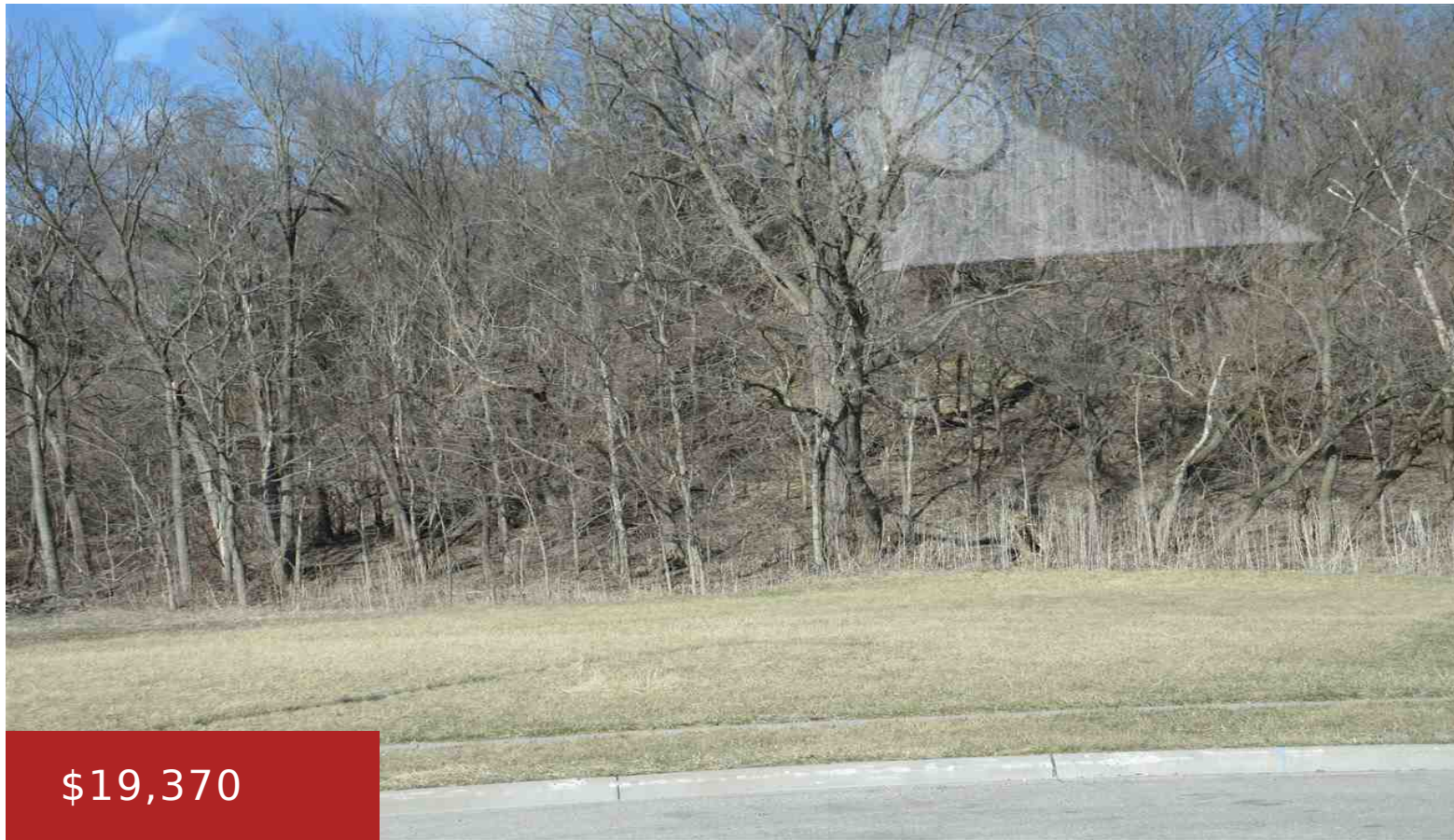

\$19,370

Located in the beautiful Driftless Area of Wi. on the SE side of Prairie du Chien you will find Woodridge Acres subdivision. Come build your dream home and enjoy the wooded bluffs.. Located close to schools the covenants and restrictions are already in place. These lots offer city utilities and amenities such as clean streets...

- Single family
- Active



Cyndi Luster
Exit Realty Driftless Group

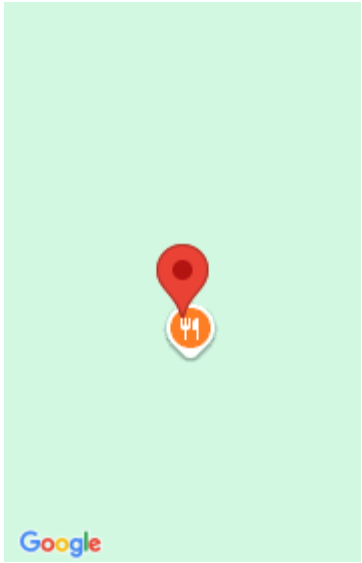

Features

GarageYN: No

AttachedGarageYN: No

FireplaceYN: No

PoolPrivateYN: No

Lot Features: Cul-De-Sac

Utilities: Natural Gas Available, Electricity Available, Phone Available, Cable Available

Tax Year: 2019

Amenities

Waterfront available: No

Water Source: Municipal water available

Sewer: Public Sewer

Building Details

NewConstructionYN: No

Agent Details

Agent Full Name: Cyndi Luster

Agent Email: cyndipdc@gmail.com