

L22 STONEHAVEN DRIVE, GREEN LAKE, WI, 54941

https://www.adashunjones.com

L22 Stonehaven
Drive, Green Lake,
WI, 54941

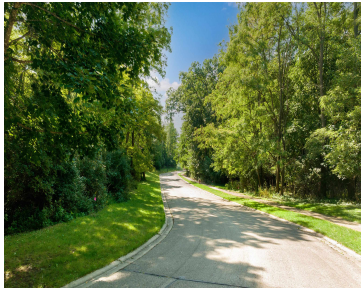
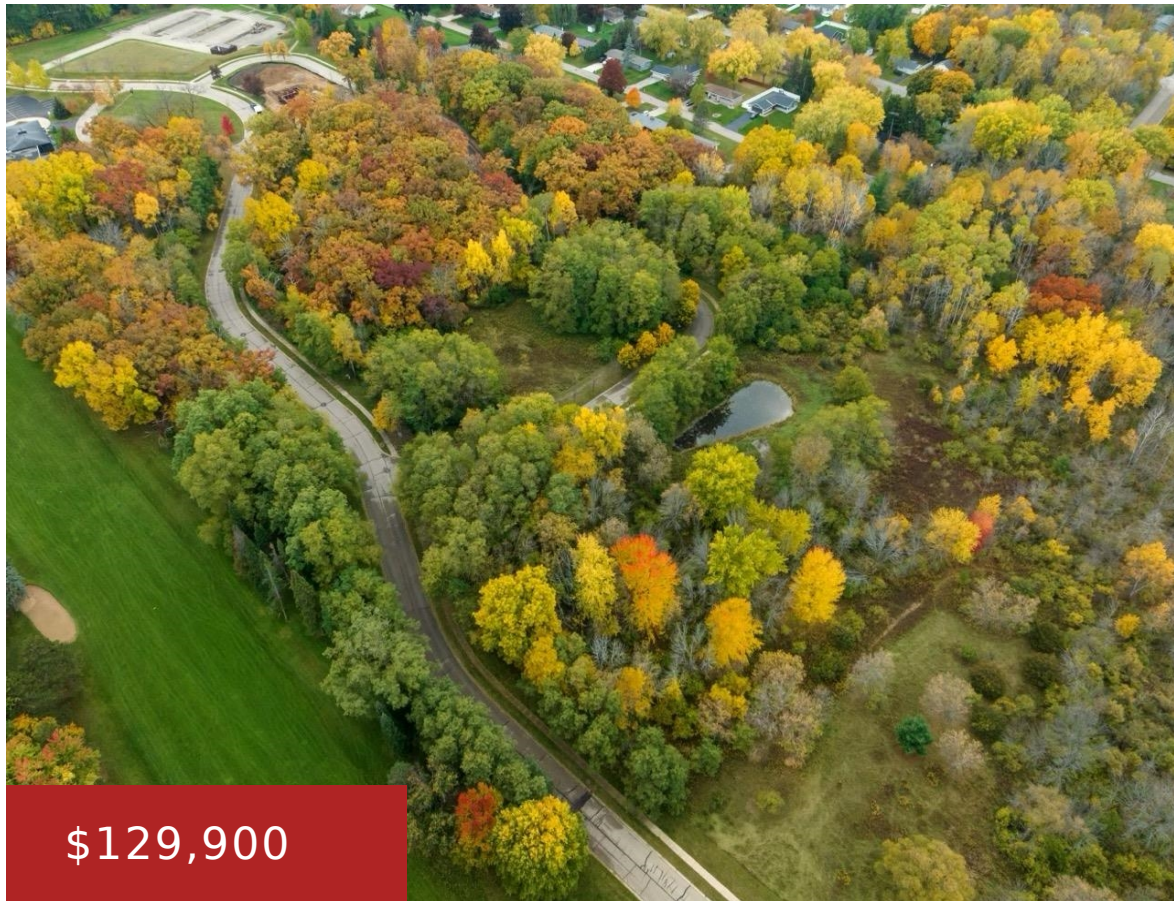

\$129,900

Evensong Estates is Green Lakes newest subdivision set amongst areas of mature hardwood trees and beautiful meadows. Located right in the heart of downtown Green Lake boasting residential lots having approximately one half acre each in size. Lots are within walking distance of all that Green Lake has to offer: Shops, restaurants, churches, parks (including...

- Single family
- Active



Jeffrey Shadick
Better Homes and Gardens Real Estate Special Properties

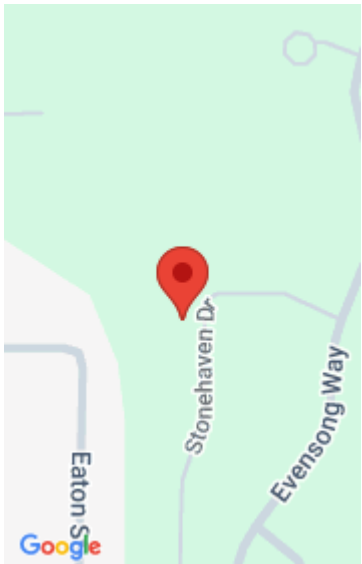

Features

GarageYN: No

AttachedGarageYN: No

FireplaceYN: No

PoolPrivateYN: No

Lot Features: On Golf Course

Utilities: Natural Gas Available, Electricity Available, Phone Available

Tax Year: 2025

Tax Amount: 1671

Amenities

Waterfront available: No

Water Source: Municipal water available

Sewer: Public Sewer

Building Details

NewConstructionYN: No

Agent Details

Agent Full Name: Jeffrey Shadick

Agent Email: jeff@special-properties.com