

L21 STONEHAVEN DRIVE, GREEN LAKE, WI, 54941

https://www.adashunjones.com

L21 Stonehaven  
Drive, Green Lake,  
WI, 54941

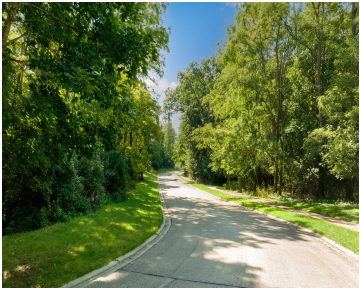
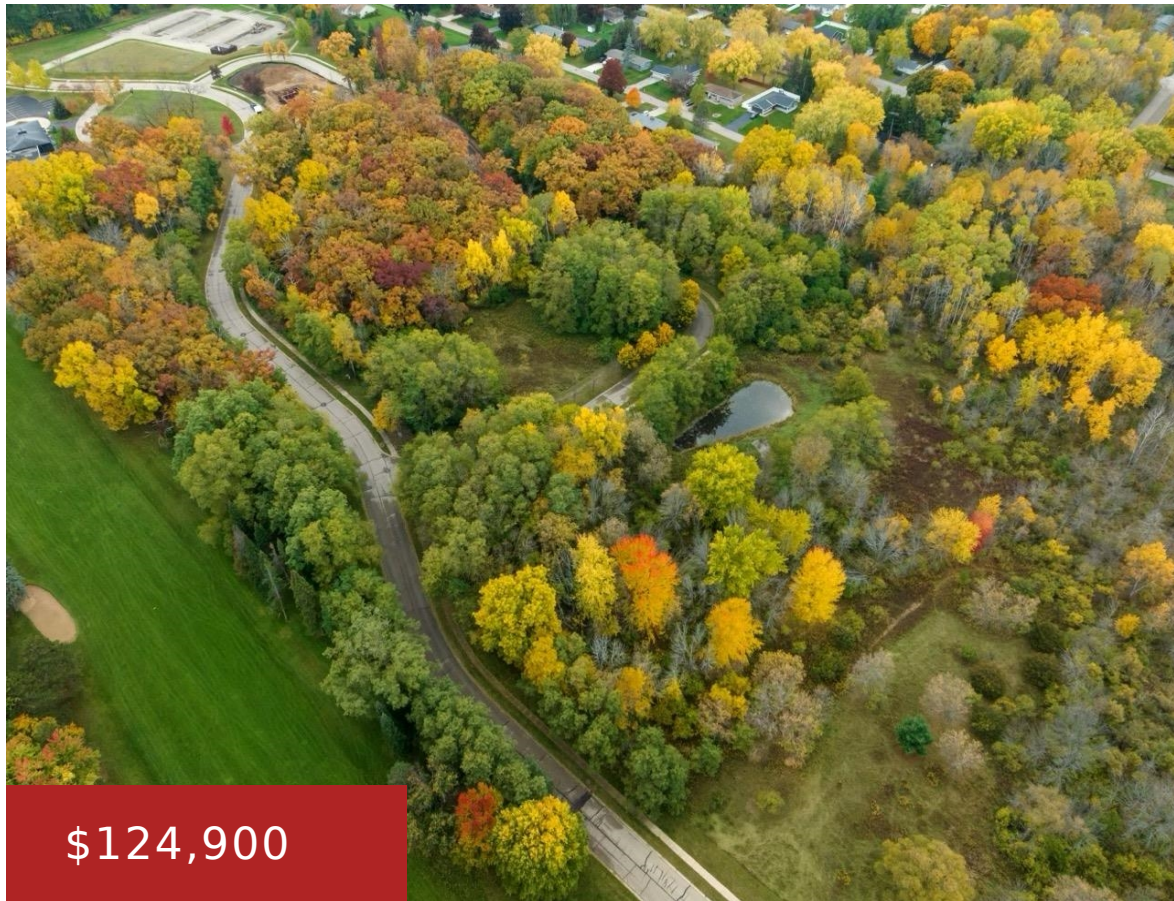

\$124,900

Evensong Estates is Green Lakes newest subdivision set amongst areas of mature hardwood trees and beautiful meadows. Located right in the heart of downtown Green Lake boasting residential lots having approximately one half acre each in size. Lots are within walking distance of all that Green Lake has to offer: Shops, restaurants, churches, parks (including...

- Single family
- Active



**Jeffrey Shadick**  
Better Homes and Gardens Real Estate Special Properties

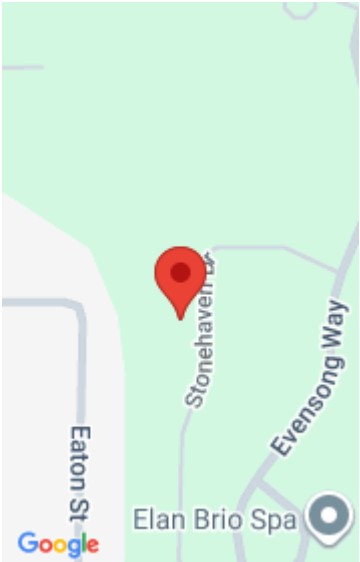

---

# Features

<b>GarageYN:</b> No	<b>AttachedGarageYN:</b> No
<b>FireplaceYN:</b> No	<b>PoolPrivateYN:</b> No
<b>Lot Features:</b> On Golf Course	<b>Utilities:</b> Natural Gas Available, Electricity Available, Phone Available
<b>Tax Year:</b> 2025	<b>Tax Amount:</b> 1671

---

# Amenities

<b>Waterfront available:</b> No	<b>Water Source:</b> Municipal water available
<b>Sewer:</b> Public Sewer	

---

# Building Details

**NewConstructionYN:** No

---

# Agent Details

<b>Agent Full Name:</b> Jeffrey Shadick	<b>Agent Email:</b> jeff@special-properties.com
---	---