

L2 CHALET STREET, MIDDLETON, WI, 53562

https://www.adashunjones.com

L2 Chalet Street,
Middleton, WI,
53562

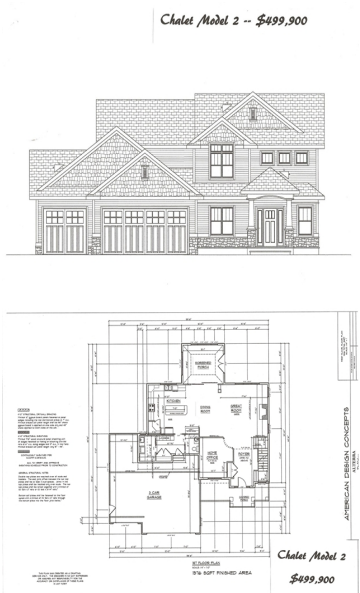
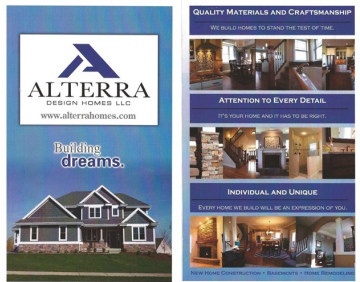

Sunset Ridge Elementary, new home by Alterra Design Homes, 1 acre lot backing to mature trees in red hot Chalet Meadows in the Town of Middleton! There is a lot to love about this rare opportunity to build a beautiful, affordable home in value-enhancing neighborhood. 4 Beds, Huge 3 Car garage, office, main floor laundry,...

- 4 beds
- 2 baths
- Res
- Sold
- 2644 sq ft



Jason Kratochwill
Keller Williams Realty

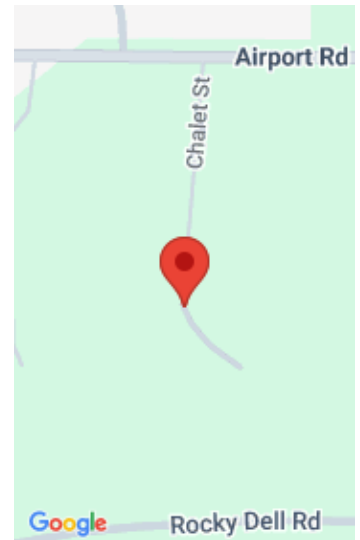

Features

GarageYN: Yes

AttachedGarageYN: Yes

FireplaceYN: No

PoolPrivateYN: No

Lot Features: Cul-De-Sac,
Subdivided

Features: Dryer,Gas,Kitchen Island,Main
Level,Pantry,Walk-in Closet(s),Washer,Water softener
inc

Above Grade Finished Area, sq ft: 2644
Tax Year: 2011

Amenities

Waterfront available: No

Cooling:
Central Air

Amenities: Dishwasher,Disposal,Dryer,ENERGY STAR Qualified
Appliances,Microwave,Range,Refrigerator,Washer,Water Softener Owned

**Water
Source:** Well

Sewer: Private Sewer

Building Details

NewConstructionYN: No

Heating: Forced Air, Natural Gas

Basement: Bath/Stubbed,Full,Full Size
Windows/Exposed,Sump Pump

Exterior material: Brick,Pressed
board,Stone,Stucco

Parking: Attached,Paved

Agent Details

Agent Full Name: Jason Kratochwill

Agent Email: jason@jasonthomashomes.com