

L1 MINERAL POINT ROAD, MIDDLETON, WI, 53593

<https://www.adashunjones.com>

L1 Mineral Point Road, Middleton, WI, 53593

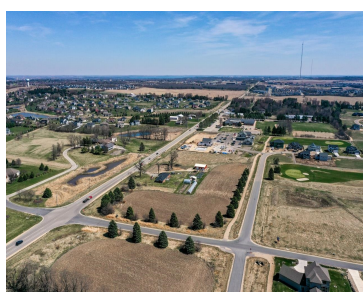
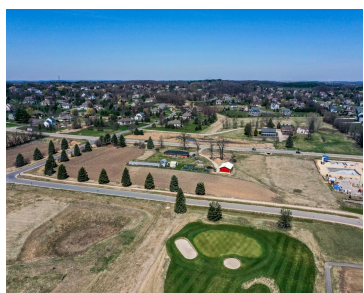
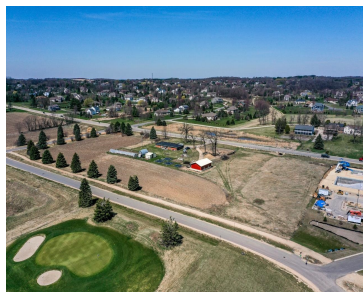

Rare Town of Middleton Commercial Land. 5.9 acres zoned GC on Mineral Point Rd. Adjacent to Golf Course. Close to gas station and school. Great visibility and surrounded by numerous popular subdivisions.



Tommy Van Ess
First Weber Inc

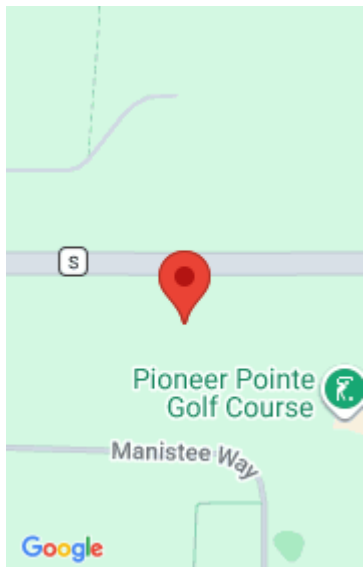

Features

Days on Market: 542

Parcel Number: 0708-301-0001-0

AttachedGarageYN: No

PoolPrivateYN: No

Utilities: Natural Gas Available, Electricity Available,
Phone Available, Cable Available

Tax Year: 2022

Tax Amount: \$29

Lot Size, acres: 5.97

GarageYN: No

FireplaceYN: No

Lot Features: , Corner Lot, On Golf
Course

Water Source: Well required

Sewer: Public Sewer

Building Details

NewConstructionYN: No

Agent Details

Agent Full Name: Tommy Van Ess

Agent Email: vanesst@firstweber.com