

KORD COURT, OCONTO, WI, 54153

<https://www.adashunjones.com>

KORD Court,
OCONTO, WI,
54153



\$25,000

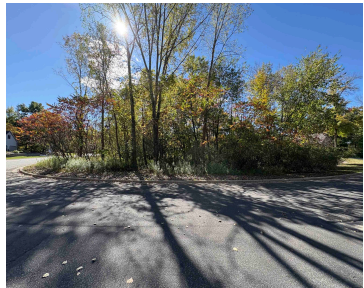
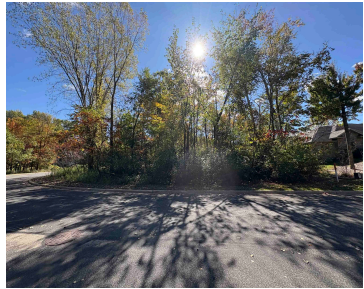

Rapid River Estates is home to this stunning 0.44 acre property, situated on a coveted corner lot with a serene shared pond. Surrounded by a wooded area, the property exudes tranquility, making it an attractive option for those seeking a peaceful retreat. Per building inspector, "The lot is buildable, the setback(s) would be determined on...



Mercedes
Copperleaf, LLC

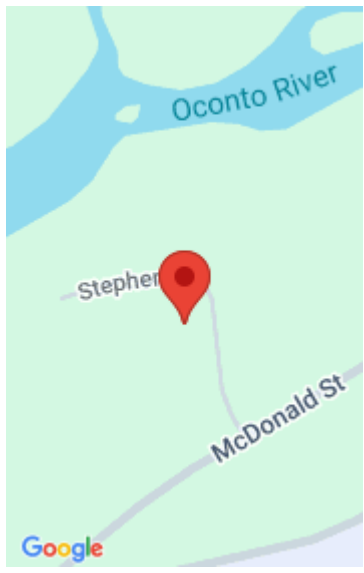

Features

Price per sq ft: \$56,818.18

Lot Size, acres: 0.44

For Sale or Rent: For Sale

GarageYN: No

FireplaceYN: No

Lot Features: Corner Lot, Wooded

Water Source: None

Tax Amount: \$438

Lot size, sq ft: 19166 acres

Subdivision Name: Rapid River Estates

Parcel Number: 26533240972178K

AttachedGarageYN: No

PoolPrivateYN: No

Utilities: None

Sewer: None

Building Details

NewConstructionYN: No

Agent Details

Agent Full Name: Mercedes M. Gibeault **Agent Email:** mercedes@copperleafrealtyteam.com