

E9640 WOODS EDGE DRIVE, FREMONT, WI, 54940

https://www.adashunjones.com

E9640 WOODS
EDGE Drive,
FREMONT, WI,
54940



\$59,000



Quietly nestled in the serene Whispering Winds subdivision, this 1.2-acre parcel offers a peaceful retreat with rolling terrain and picturesque pond views. Perfect for building your first home or your dream home, this lot is surrounded by nature and provides a tranquil setting. Conveniently located between Appleton, Oshkosh, and Waupaca, it offers easy access to...

- Land
- Residential,Vacant Land/Acreage
- Active



Miles
Coldwell Banker Real Estate Group

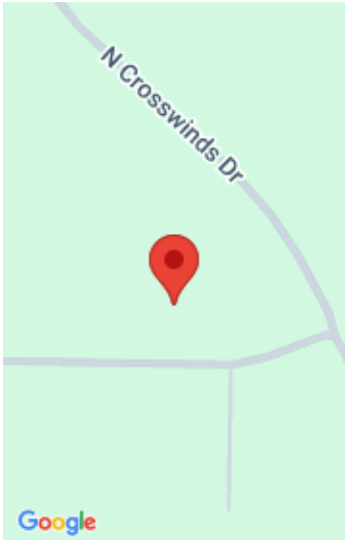

Features

GarageYN: No

FireplaceYN: No

Lot Features: Rolling Slope, Rural - Subdivision

Features: High Speed Internet

AttachedGarageYN: No

PoolPrivateYN: No

Utilities: Electricity Available, Natural Gas Available, Phone Available

Tax Amount: 86.7

Amenities

Waterfront available: No

Sewer: None

Water Source: None

Building Details

NewConstructionYN: No

Agent Details

Agent Full Name: Miles Van Asten

Agent Email: mvanasten@coldwellhomes.com