

810 BESSY LANE, CHILTON, WI, 53014

https://www.adashunjones.com

810 BESSY Lane,
CHILTON, WI,
53014

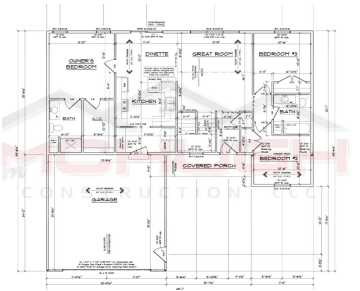

Welcome Home from Tom McHugh Construction. Home will be complete and ready for you to move into by Mid October. Featuring a 3 bedroom split ranch design, 1 egress window, insulated garage doors, 2 car garage, and central AC. Full driveway to street included, developer installed streets, no street assesments. Front image is computer generated....



Tom
Score Realty Group, LLC



Stephanie
Score Realty Group, LLC

- 3 beds
- 2 baths
- Residential
- Residential,Single Family Residence
- Active
- 1328 sq ft

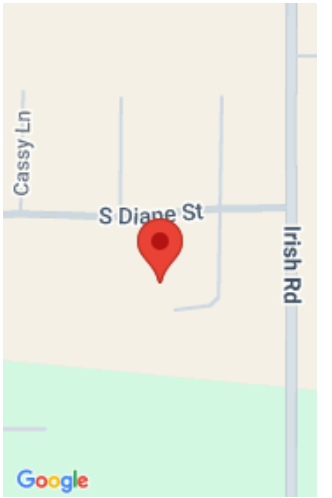

Features

GarageYN: No
FireplaceYN: No
Features: None
Inclusions: Dishwasher and Microwave

AttachedGarageYN: No
PoolPrivateYN: No
Above Grade Finished Area, sq ft: 1328

Amenities

Waterfront available: No
Amenities: Dishwasher,Microwave
Sewer: Public Sewer

Cooling: Central Air
Water Source: Public

Room Sizes

Room type	Dimensions	Level
Bedroom 1	14x12	Main
Bedroom 2	11x10	Main
Bedroom 3	11x10	Main
Kitchen	9x11	Main
Living Room	14x16	Main
Dining Room	11x8	Main
Other Room	11x6	Main

Building Details

NewConstructionYN: No

Basement: Finished,Full

Parking: Attached

Heating: Forced Air

Exterior material: Vinyl Siding

Agent Details

Agent Full Name: Tom McHugh

Agent Email: Tom@ScoreRealtyGroup.com