

7645 GRINDE, WINDSOR, WI, 53532-2018

<https://www.adashunjones.com>

7645 Grinde,
Windsor, WI,
53532-2018



\$215,900

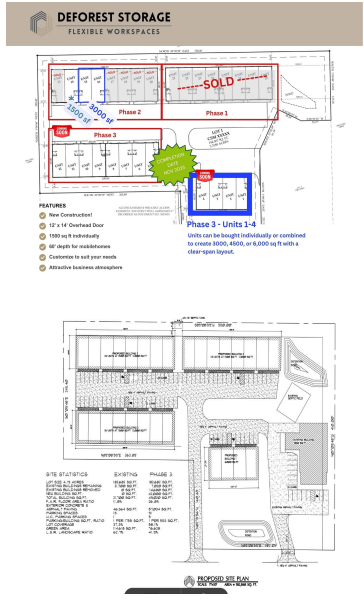

• 1500 sq ft

Completion Date: 01/31/26. Sought-after storage/workspace condos are now available in Windsor-DeForest (Phases 3 & 4)! Each spacious 1,500 SF unit (60' deep) offers the perfect solution for small business owners, contractors, hobbyists, or RV/boat enthusiasts looking for a secure and flexible space. High-quality construction includes LP SmartSide exterior, a 12' x 14' motorized overhead door,...



Kim Elton
Realty Executives Cooper Spransy



Features

Days on Market: 150

Area, sq ft: 1,500 sq ft

Parcel Number: 0910-054-6142-1

AttachedGarageYN: No

Cooling: Other

PoolPrivateYN: No

Lot Features: 0.118

Tax Year: 2025

Floors: 1 floor

Year built: 2025

GarageYN: No

Heating: Natural Gas

FireplaceYN: No

Security Features: Security Lights

Water Source: Well

Sewer: Private Sewer

Building Details

NewConstructionYN: No

Roof: Composition

Exterior Material: Other

Agent Details

Agent Full Name: Kim Elton

Agent Email: kelton@realtyexecutives.com