

691 LIME ROCK PLACE 25, ASHWAUBENON, WI, 54115

https://www.adashunjones.com

691 LIME ROCK  
Place 25,  
Ashwaubenon, WI,  
54115

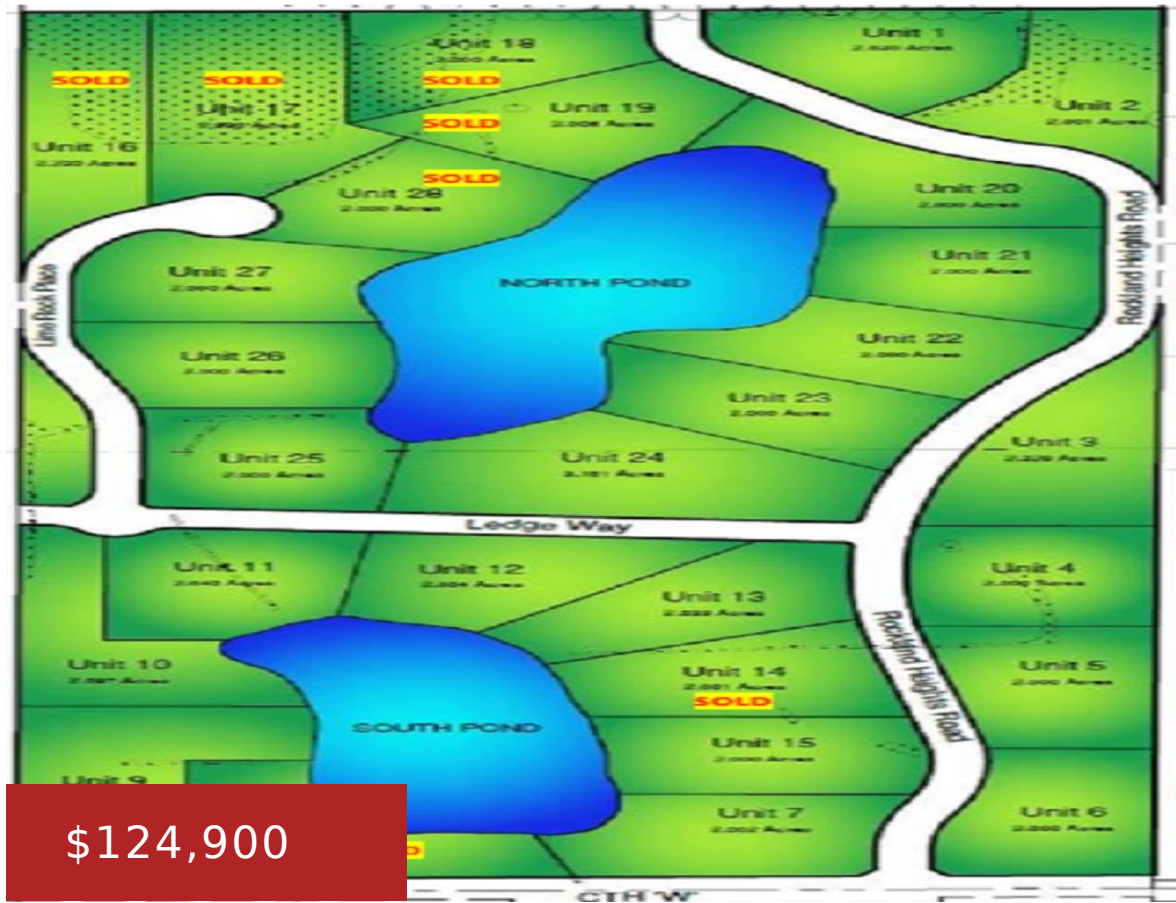

Located in pastoral Rockland, WI, 10 mins from De Pere. 28 exclusive, 2+ acre, homesites within a 78-acre site. Most homesites provide pond frontage on 2 separate maintained ponds. Additional sites provide scenic views, or rear wooded settings. Many sites suitable for exposed lower-levels. Set within a land condo. assoc.; homeowners are safeguarded by covenants,...

- Land
- Residential,Vacant Land/Acreage
- Active



**Gary**  
Coldwell Banker Real Estate Group



**Bryan**  
Coldwell Banker Real Estate Group

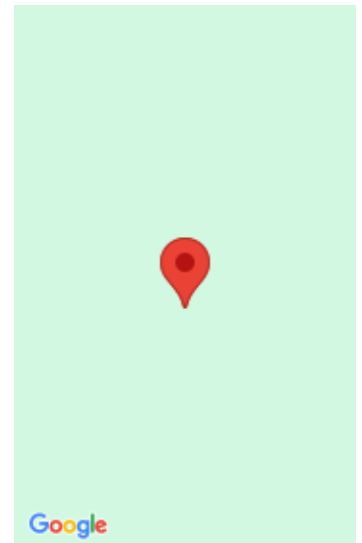

---

## Features

**GarageYN:** No

**FireplaceYN:** No

**Lot Features:** Existing Condo Plat, Exposed LL Possible, Rural - Subdivision

**Tax Amount:** 55

**AttachedGarageYN:** No

**PoolPrivateYN:** No

**Utilities:** Cable Available, Electricity Available, Gas, Telephone Line

---

## Amenities

**Waterfront available:** No

**Sewer:** None

**Water Source:** No Water

---

## Building Details

**NewConstructionYN:** No

---

## Agent Details

**Agent Full Name:** Gary Kaster

**Agent Email:** gkaster@coldwellhomes.com