

# 630 FRONTAGE S ROAD, WISCONSIN DELLS, WI, 53965

<https://www.adashunjones.com>

630 Frontage S  
Road, Wisconsin  
Dells, WI, 53965

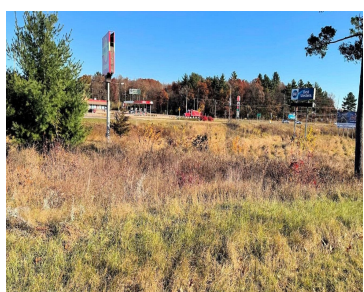

Approximately 2.6 +/- acres zoned C-4 on State Hwy located off I-90/94 exit into Wisconsin Dells. Excellent signage on Hwy 13 off freeway exit. Equipped restaurant on the property. Located in a high-traffic area of the Wisconsin Dells, next to motels and gas stations. Close to several attractions & shopping areas. Excellent location for future...



**Jennifer Sagissor**  
First Weber Inc

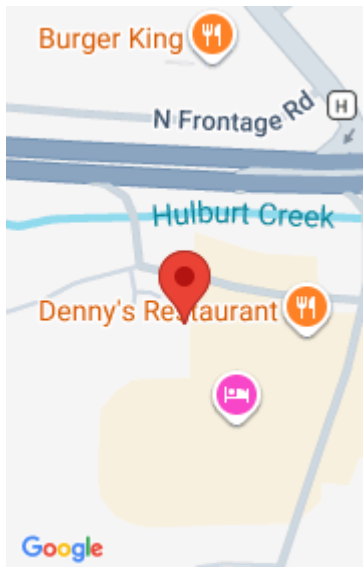

## Features

**Days on Market:** 183

**Lot Size, acres:** 2.61

**Parcel Number:** 291-0089-30000

**GarageYN:** No

**AttachedGarageYN:** No

**FireplaceYN:** No

**PoolPrivateYN:** No

**Utilities:** Natural Gas Available, Electricity Available

**Water Source:** Municipal water available **Tax Year:** 2025

**Sewer:** Public Sewer

**Tax Amount:** \$12,772

---

## Building Details

**NewConstructionYN:** No

---

## Agent Details

**Agent Full Name:** Jennifer Sagissor

**Agent Email:** sagissorj@firstweber.com