

503 RIDGE DRIVE, MAZOMANIE, WI, 53560

<https://www.adashunjones.com>

503 Ridge Drive,
Mazomanie, WI,
53560

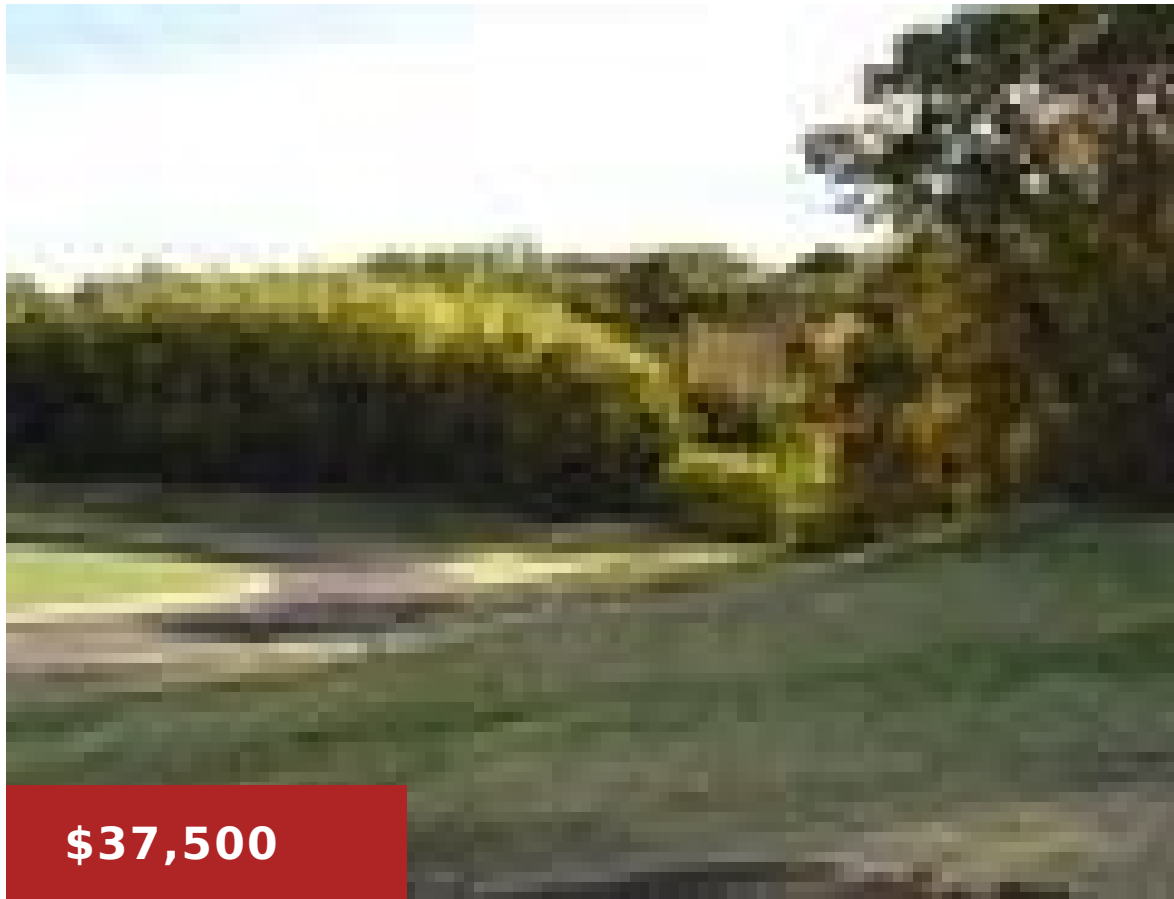

\$37,500

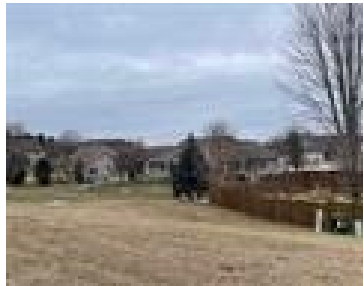

Beautiful Subdivision located in the charming community of Mazomanie. This is a wooded lot with a nice slope to the front which will offer nice exposure. Pheasant Ridge is just minutes from Middleton, Madison, Mt. Horeb, & Cross Plains. Urban Conveniences with the natural beauty of the Lower Wisconsin River, wooded hillsides, walking trails, and...



Dan Heffron
Bunbury & Assoc, REALTORS

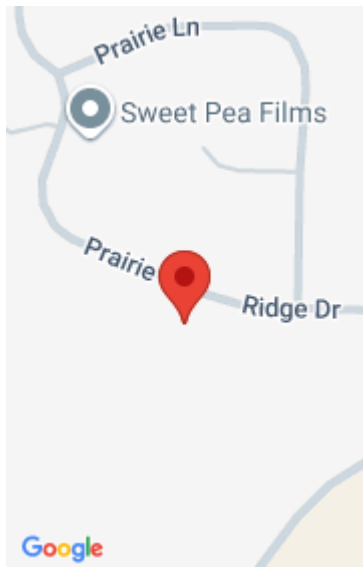

Features

Days on Market: 694

Subdivision Name: Pheasant Ridge Run

GarageYN: No

FireplaceYN: No

Lot Features: Wooded

Water Source: Municipal water available

Sewer: Public Sewer

Lot Size, acres: 0.29

Parcel Number: 0806-174-0166-1

AttachedGarageYN: No

PoolPrivateYN: No

Utilities: Natural Gas Available, Electricity Available, Phone Available, Cable Available, Underground Utilities

Tax Year: 2022

Tax Amount: \$679

Building Details

NewConstructionYN: No

Agent Details

Agent Full Name: Dan Heffron

Agent Email: danheffron@bunburyrealtors.com