

# 4816 ROMAINE ROAD, FITCHBURG, WI, 53711

<https://www.adashunjones.com>

4816 Romaine Road, Fitchburg, WI, 53711



**\$554,900**

### SEQUOIA

4 bedrooms | 2.5 bathrooms | From 2,113 square feet

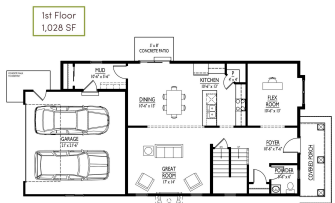

### SEQUOIA

4 bedrooms | 2.5 bathrooms | From 2,113 square feet



Under construction; estimated completion 6/16/26. Welcome to Terravessa! Cook's kitchen features quartz countertops, granite sink, ceramic tile backsplash, slate appliances, and walk-in pantry. Open floor plan to dining area with walkout to patio, and large great room including gas fireplace. Bonus flex room with glass double doors for office, playroom, etc. Spacious owner's suite features...

• 2113 sq ft



**Cari Wuebben**  
Encore Real Estate Services, I

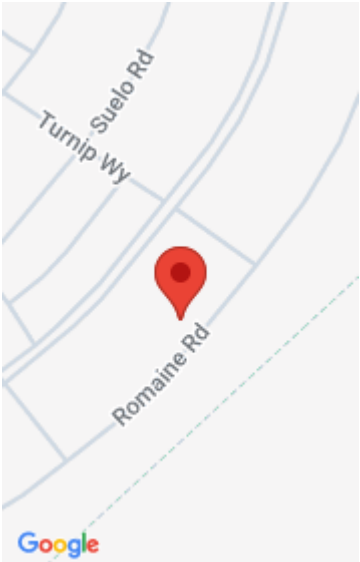

---

## Features

**Days on Market:** 102

**Lot Size, acres:** 0.11

**Subdivision Name:** Terravessa

**Association Fee:** 200

**GarageYN:** Yes

**Heating:** Forced Air, Natural Gas

**FireplaceYN:** Yes

**Community Features:** Sidewalks

**Amenities:** Dishwasher, Disposal, Microwave, Range, Refrigerator, Water Softener Owned

**Water Source:** Public

**Sewer:** Public Sewer

**Area, sq ft:** 2,113 sq ft

**Year built:** 2026

**Garage Spaces:** 2

**Parcel Number:** 0609-121-0864-2

**AttachedGarageYN:** Yes

**Cooling:** Central Air

**PoolPrivateYN:** No

**Features:** Accessible Doors, Accessible Hallway(s), Gas, Pantry, Upper Level, Walk-in Closet(s), Water softener inc

**Above Grade Finished Area, sq ft:** 2113

**Tax Year:** 2025

**Tax Amount:** \$1,331

---

## Building Details

**NewConstructionYN:** Yes

**Exterior Material:** Pressed board, Stone, Vinyl Siding

**Basement:** Bath/Stubbed, Concrete, Full, Sump Pump

**Parking:** Alley Access, Attached, Garage Door Opener, Paved

---

## Agent Details

**Agent Full Name:** Cari Wuebben

**Agent Email:** cari.wuebben@encorehomesinc.com