

416 STONEHAVEN DRIVE, GREEN LAKE, WI, 54941

https://www.adashunjones.com

416 StoneHaven Drive, Green Lake, WI, 54941

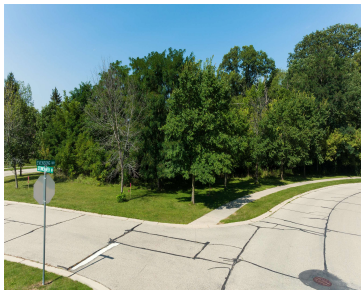

\$124,900

Evensong Estates is Green Lake’s newest subdivision set amongst areas of mature hardwood trees and beautiful meadows. Located right in the heart of downtown Green Lake boasting nineteen (19) residential lots having approximately one half acre each in size. Big Green Lake boat slip rentals are available while supplies last. Lots are within walking distance...

- Single family
- Active - Offer-Bump



Sarah Loberg
Better Homes and Gardens Real Estate Special Properties



Features

GarageYN: No	AttachedGarageYN: No
FireplaceYN: No	PoolPrivateYN: No
Lot Features: On Golf Course	Utilities: Natural Gas Available, Electricity Available, Phone Available
Tax Year: 2024	Tax Amount: 1164

Amenities

Waterfront available: No	Water Source: Municipal water available
Sewer: Public Sewer	

Building Details

NewConstructionYN: No

Agent Details

Agent Full Name: Sarah Loberg	Agent Email: sarah@special-properties.com
--------------------------------------	--