

3936 KESTREL POINT DRIVE, JANESVILLE, WI, 53548

<https://www.adashunjones.com>

3936 Kestrel Point  
Drive, Janesville,  
WI, 53548

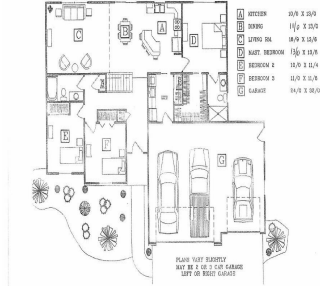

Quality built new construction 3 bedroom, 2 bath ranch located in the quiet & desirable Rockport Ridge subdivision. Features include open floor plan with hardwood flooring in the foyer/dining/kitchen. Split bedroom design with the master suite having a private bath and walk-in closet. Kitchen has beautiful birch cabinets, breakfast bar and pantry. Main floor laundry....

- 3 beds
- 2 baths
- R1
- Sold
- 1528 sq ft

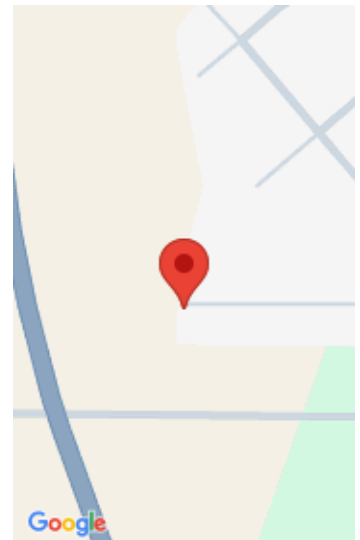

---

## Features

**GarageYN:** Yes

**FireplaceYN:** No

**Features:** Accessible Bedroom, Accessible Full Bath, Breakfast Bar, Main Level, Pantry, Vaulted Ceiling(s), Walk-in Closet(s)

**Tax Year:** 2014

**AttachedGarageYN:** No

**PoolPrivateYN:** No

**Above Grade Finished Area, sq ft:** 1528

**Tax Amount:** 825

---

## Amenities

**Waterfront available:** No

**Amenities:** Dishwasher, Disposal, Microwave

**Sewer:** Public Sewer

**Cooling:** Central Air

**Water Source:** Public

---

## Building Details

**NewConstructionYN:** No

**Basement:** Bath/Stubbed, Full

**Parking:** Detached, Paved

**Heating:** Forced Air, Natural Gas

**Exterior material:** Vinyl Siding

---

## Agent Details

**Agent Full Name:** Paul Schieldt

**Agent Email:** paulschieldt@charter.net