

2836 PLEASANT VIEW ROAD, WI, 53562

https://www.adashunjones.com

2836 Pleasant View Road, WI, 53562

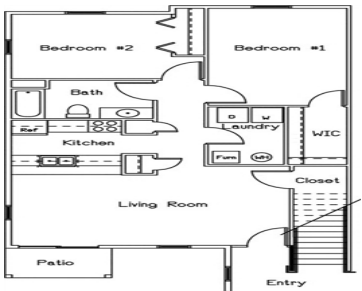

FHA approved and special 30 yr financing. Prairie/Craftsman style, spacious 2 bdrm condo home high on hill with great views. Condo includes private garages, deck/patio, and laundry. Large master bdrm walkin closet, high efficiency furnace, energy efficient windows and construction matierials. Down PMT assistance avail. Take Beltline Hwy towards Middleton, go west on Airport Rd,...

- 2 beds
- 1 bath
- Condominium,PUD
- Sold
- 998 sq ft



Thomas Ellefson
The Ellefson Companies

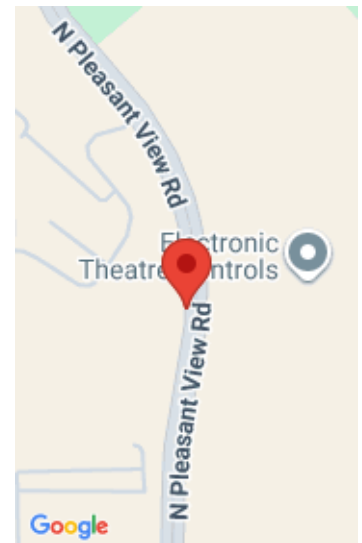

Features

GarageYN: Yes

FireplaceYN: No

Lot Features: Near Public Transit

Above Grade Finished Area, sq ft: 998 **Tax Year:** 2010

Tax Amount: 2500

AttachedGarageYN: Yes

PoolPrivateYN: No

Features: Accessible Doors,Breakfast Bar,Main Level,Walk-in Closet(s)

Amenities

Waterfront available: No

Amenities: Dishwasher,Disposal,Microwave

Sewer: Public Sewer

Cooling: Central Air

Water Source: Public

Building Details

NewConstructionYN: No

Basement: Sump Pump

Parking: Attached,Garage,Garage Door Opener,Underground

Heating: Forced Air, Natural Gas

Exterior material:
Aluminum/Steel,Brick,Stone,Vinyl Siding

Agent Details

Agent Full Name: Thomas Ellefson

Agent Email: thomas@ellefsonconstruction.com