

2011-4 CZECH S CROSSING, WI, 54613

https://www.adashunjones.com

2011-4 Czech S Crossing, WI, 54613



\$299,900

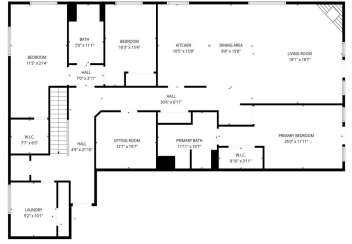

Discover the epitome of condo living in this 4BR, 2BA condo at Northern Bay on the shores of Castle Rock Lake. Pride of ownership is evident in this meticulously maintained condo overlooking the fairway of Hole #1. A seamless blend of comfort and style, the open floor plan welcomes you with a spacious kitchen boasting...

• 2238 sq ft



Dolly Coughlin Parr
Coldwell Banker Belva Parr Realty

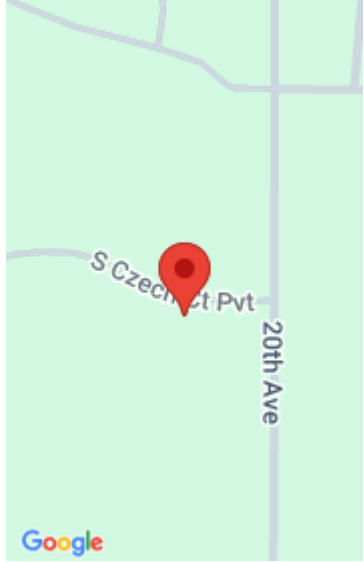

Features

Days on Market: 24

Year built: 2004

Association Fee: 600

Association Amenities: Clubhouse, Tennis Court(s), Park, Fitness Center, Spa/Hot Tub, Playground, Elevator(s), Pool, Water/Sewer, Cable TV, Trash, Snow Removal, Maintenance Grounds, Maintenance, Insurance

GarageYN: Yes

Heating: Forced Air, Electric

FireplaceYN: Yes

Utilities: Cable Available

Amenities: Dishwasher, Dryer, Microwave, Range, Refrigerator, Washer

Water Source: Public, Shared Well

Sewer: Public Sewer

Area, sq ft: 2,238 sq ft

View: Water, Lake

Association Name: Northern Bay

Parcel Number: 034-02819-0507

AttachedGarageYN: No

Cooling: Central Air

PoolPrivateYN: No

Features: Accessible Bedroom, Accessible Elevator Installed, Accessible Full Bath, Gas, Kitchen Island, Main Level, Pantry, Walk-in Closet(s)

Above Grade Finished Area, sq ft: 2238

Tax Year: 2025

Tax Amount: \$3,488

Building Details

NewConstructionYN: No

Exterior Material: Wood Siding

Basement: None

Parking: Assigned, Garage

Agent Details

Agent Full Name: Dolly Coughlin Parr

Agent Email: dollyparr@gmail.com