

1931 HOLMGREN WAY, GREEN BAY, WI, 54304

https://www.adashunjones.com

1931 HOLMGREN  
Way, GREEN BAY,  
WI, 54304

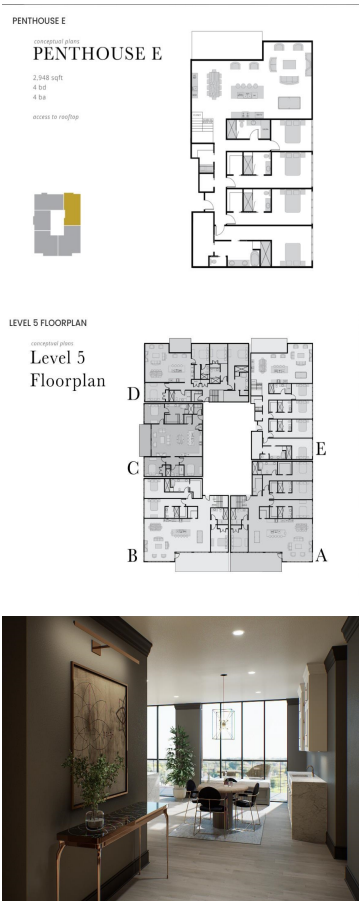

Experience luxury living in this stunning condo residence in pro football’s most historic team neighborhood! Boasting floor to ceiling windows, you’ll enjoy panoramic views of the Stadium District every day. The spacious master suites offer the ultimate in comfort and relaxation w/walk in closet, bath and sauna. The chef inspired kitchen is perfect for entertaining...

- 4 beds
- 4 baths
- Residential
- Condo,Condominium
- Active
- 2948 sq ft



**Robin**  
Realty Executives Fortitude

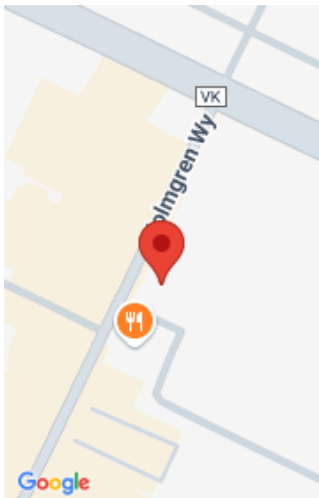

---

## Features

<b>GarageYN:</b> No	<b>AttachedGarageYN:</b> No
<b>FireplaceYN:</b> No	<b>PoolPrivateYN:</b> No
<b>ExteriorFeatures:</b> Balcony	<b>Features:</b> Gas,Kitchen Island,One,Pantry
<b>Above Grade Finished Area, sq ft:</b> 2948	<b>Inclusions:</b> Fridge, stove, microwave, dishwasher, washer, dryer
<b>Exclusions:</b> Sellers personal property	

---

## Amenities

<b>Waterfront available:</b> No	<b>Cooling:</b> Central Air
<b>Amenities:</b> Dishwasher,Dryer,Microwave,Range,Refrigerator,Washer	<b>Water Source:</b> Public
<b>Sewer:</b> Public Sewer	

---

## Room Sizes

Room type	Dimensions	Level
Bedroom 1	14x13	Main
Bedroom 2	14x11	Main
Bedroom 3	14x12	Main
Bedroom 4	14x10	Main
Kitchen	12x19	Main
Living Room	17x13	Main
Dining Room	14x19	Main

## Building Details

<b>NewConstructionYN:</b> No	<b>Heating:</b> Forced Air
<b>Exterior material:</b> Aluminum Siding,Balcony,Shake Siding,Stone	<b>Parking:</b> Assigned,Electric Vehicle Charging Station(s),Heated Garage,Underground

## Agent Details

<b>Agent Full Name:</b> Robin Baade	<b>Agent Email:</b> rb@plusonerealtygroup.com
-------------------------------------	---