

1752 WAVERLY WAY, SUN PRAIRIE, WI, 53590

<https://www.adashunjones.com>

1752 Waverly Way,
Sun Prairie, WI,
53590

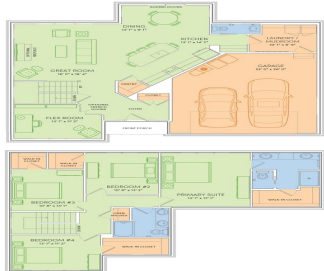

\$659,900

NTATIVE MODEL FOR COMPARISON

Move-in ready 7/8/26. This Atwood home features a thoughtfully designed, open-concept layout ideal for modern living. Offering 4 bedrooms, 2.5 baths, and a 2-car garage, this home showcases locally made, custom Auburn Ridge® cabinetry, doors, and trim crafted to last. The stylish kitchen includes a center island, quartz countertops, and quality finishes from trusted brands...

• 2446 sq ft



Jeff Greenlee
Stark Company, REALTORS



Features

Days on Market: 16

Lot Size, acres: 0.25

Subdivision Name: The Reserve

Association Fee: 130

GarageYN: Yes

Heating: Forced Air, Natural Gas

FireplaceYN: Yes

Community Features: Sidewalks

Features: Accessible Doors, Accessible Hallway(s), Breakfast Bar, Cable Available, Dryer, Gas, Kitchen Island, Main Level, Pantry, Walk-in Closet(s), Washer, Water softener inc

Above Grade Finished Area, sq ft: 2446

Tax Year: 2025

Tax Amount: \$2,275

Area, sq ft: 2,446 sq ft

Year built: 2026

Garage Spaces: 2

Parcel Number: 0911-312-4626-2

AttachedGarageYN: Yes

Cooling: Central Air

PoolPrivateYN: No

Utilities: Cable Available

Amenities: Dishwasher, Disposal, Dryer, Microwave, Range, Refrigerator, Washer, Water Softener Owned

Water Source: Public

Sewer: Public Sewer

Building Details

NewConstructionYN: No

Exterior Material: Vinyl Siding

Basement: Bath/Stubbed,Concrete,Full,Sump Pump

Parking: Attached, Garage Door Opener, Paved

Agent Details

Agent Full Name: Jeff Greenlee

Agent Email: jgreenlee@veridianhomes.com