

1447 HOFFMAN ROAD, GREEN BAY, WI, 54311

https://www.adashunjones.com

1447 HOFFMAN  
Road, GREEN BAY,  
WI, 54311



\$399,900

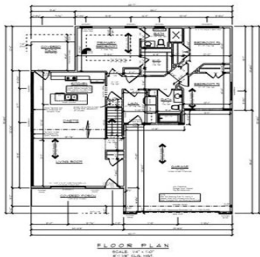

Siding	Cerise
Front Elevation	Board & Batten-Hudson Slate
Right Elevation	D4-Hudson Slate
Left Elevation	D4-Hudson Slate
Back	D4-Hudson Slate
Corners	White
Trim	
Urinals	White
Fascia/D-Edge/Soffit	White
Columns	N/A
Roofing	Cedar/Feed On/wood
Garage Doors	
Color	White
Profile	Vertical Long Panel
Windows	Clear Long
Frame	White

Interior Selections

Paint color: Agreeable Gray  
Cabinet Hardware: Nickel  
Cabinet Color: Stain - Fawn  
Countertops: Trends Quartz Glacier Peak  
Doors and Trim: Painted - White Dove

Luxury new build ranch home by Bartolazzi Custom Builders. Be the first to own this spacious, open layout home. Main level includes cathedral ceilings in great room which opens to kitchen with center island, and dining area. Primary suite with huge walk-in closet, en-suite with walk-in shower. Convenient layout with two additional bedrooms and full...



**Ben**  
Ben Bartolazzi Real Estate, Inc

- 3 beds
- 2 baths
- Residential
- Residential,Single Family Residence
- Active
- 1408 sq ft

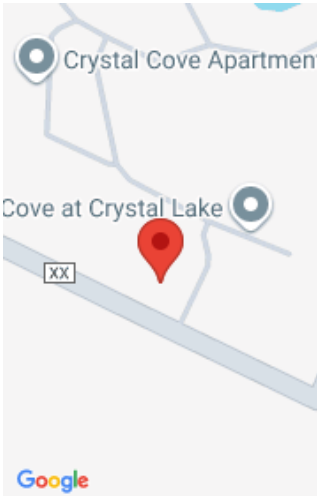

---

## Features

**GarageYN:** No

**FireplaceYN:** No

**Features:** At Least 1 Bathtub,Kitchen Island,None,Pantry,Vaulted Ceiling(s),Walk-in Closet(s),Walk-in Shower,Wood/Simulated Wood Fl

**Tax Amount:** 312.17

**Exclusions:** Seller's personal property.

**AttachedGarageYN:** No

**PoolPrivateYN:** No

**Above Grade Finished Area, sq ft:** 1408

**Inclusions:** Refrigerator, Oven/range, Dishwasher, Microwave, 12x12 Concrete Patio, Disposal.

---

## Amenities

**Waterfront available:** No

**Cooling:** Central Air

**Amenities:** Dishwasher,Disposal,Microwave,Range,Refrigerator

**Water Source:** Public

**Sewer:** Public Sewer

---

## Room Sizes

Room type	Dimensions	Level
Bedroom 1	13x12	Main
Bedroom 2	10x10	Main
Bedroom 3	10x10	Main
Kitchen	15x9	Main
Living Room	15x12	Main
Dining Room	15x10	Main
Other Room	9x7	Main

## Building Details

**NewConstructionYN:** No

**Heating:** Forced Air

**Exterior material:** Stone,Vinyl Siding

**ArchitecturalStyle:** Ranch

**Basement:** Full,Full Sz Windows Min 20x24,Stubbed for Bath,Sump Pump

**Parking:** Attached

## Agent Details

**Agent Full Name:** Ben M Bartolazzi

**Agent Email:** ben@benbarto.com