

1421 STONEHAVEN DRIVE, SUN PRAIRIE, WI, 53590-2531

<https://www.adashunjones.com>

1421 Stonehaven
Drive, Sun Prairie,
WI, 53590-2531



\$750,000

FRONT ELEVATION
1/4" = 1'

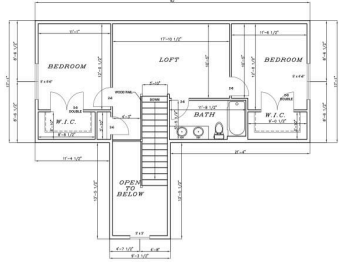
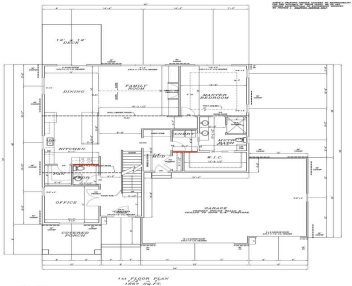

• 2357 sq ft

Discover how affordable your dream home can be with Maverick Homes. This new custom-built 1.5-story ranch combines the value of a semi-custom design with the quality and care you'd expect from a fully custom homebuilder. The open-concept main level is designed for both everyday living and entertaining, featuring spacious living areas, high-quality finishes, and an...



Cindy Ulsrud
Realty Executives Cooper Spransy

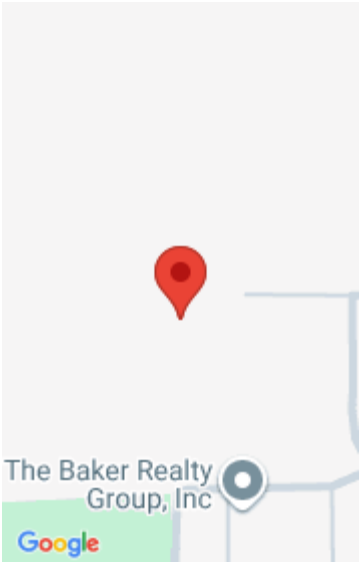

Features

Days on Market: 110

Lot Size, acres: 0.25

Subdivision Name: Liberty Square West

Parcel Number: 0911-313-1400-2

AttachedGarageYN: Yes

Cooling: Central Air

PoolPrivateYN: No

Amenities: Dishwasher, Microwave, Range, Refrigerator, Water Softener Owned

Water Source: Public

Sewer: Public Sewer

Area, sq ft: 2,357 sq ft

Year built: 2026

Garage Spaces: 3

GarageYN: Yes

Heating: Forced Air, Natural Gas

FireplaceYN: Yes

Features: Accessible Bedroom, Accessible Full Bath, Gas, Kitchen Island, Main Level, Pantry, Walk-in Closet(s), Water softener inc

Above Grade Finished Area, sq ft: 2357

Tax Year: 2024

Tax Amount: \$28,725

Building Details

NewConstructionYN: No

Basement: Full

Exterior Material: Vinyl Siding **Parking:** Attached, Garage Door Opener, Paved

Agent Details

Agent Full Name: Cindy Ulsrud

Agent Email: cindyu@realtyexecutives.com