

1055 TAPLIN DRIVE, WAUTOMA, WI, 54982

https://www.adashunjones.com

1055 TAPLIN Drive,
WAUTOMA, WI,
54982



\$484,000

New construction! 3 bed 2 bath home at 1616 sq feet on a large 1.4+ acre lot. While the lesser sq footage keeps this home economical the well designed layout will make this home feel spacious and welcoming. The home will feature 2 large covered porches, LVP flooring, premium vinyl siding, forced air furnace and...



John
First Weber, Inc.



John
First Weber, Inc.

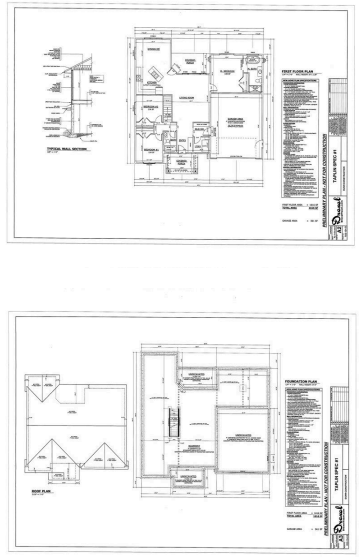

- 3 beds
- 2 baths
- Residential
- Residential, Single Family Residence
- Active
- 1616 sq ft

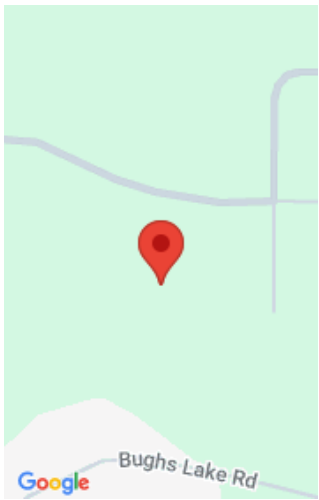

Features

GarageYN: No

AttachedGarageYN: No

FireplaceYN: No

PoolPrivateYN: No

Features: None

Above Grade Finished Area, sq ft: 1616

Amenities

Waterfront available: No

Cooling: Central Air

Water Source: Well

Sewer: Conventional Septic

Room Sizes

Room type	Dimensions	Level
Bedroom 1	15x13	Main
Bedroom 2	10x11	Main
Bedroom 3	11x11	Main
Family Room	15x12	Main
Kitchen	11x14	Main
Dining Room	11x14	Main
Other Room	6x11	Main

Building Details

NewConstructionYN: No

Basement: Full

Parking: Attached

Heating: Forced Air

Exterior material: Vinyl Siding

Agent Details

Agent Full Name: John D Eagan

Agent Email: john.d.eagan@firstweber.com