

1002 MATTHEW LANE, KAUKAUNA, WI, 54130

https://www.adashunjones.com

1002 MATTHEW Lane, KAUKAUNA, WI, 54130

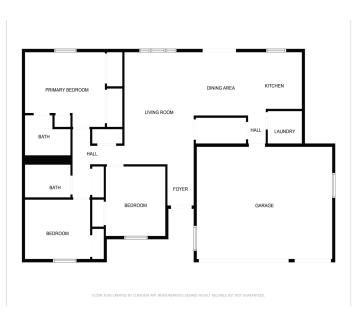

\$339,900

Beautifully Landscaped ¼+ Acre Setting! The living room features vaulted ceilings and large windows overlooking the back yard. The kitchen is fully applianced with generous storage, luxury plank flooring, and a dining area with sliding glass doors leading to a relaxing patio and expansive backyard. All bedrooms are on the main level, including the primary...

- 3 beds
- 2 baths
- Residential
- Residential,Single Family Residence
- Active
- 1363 sq ft



Julie
Todd Wiese Homeselling System, Inc.



Alex
Todd Wiese Homeselling System, Inc.

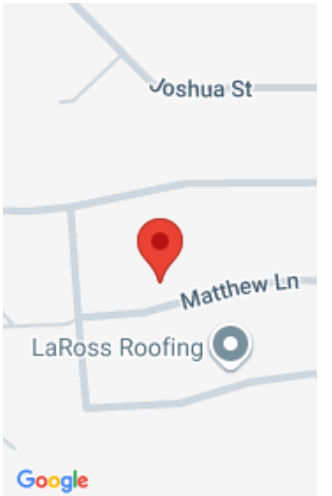

Features

GarageYN: No

FireplaceYN: No

Features: At Least 1 Bathtub,Cable Available,Hi-Speed Internet Availbl,None,Vaulted Ceiling(s),Wood/Simulated Wood Fl

Tax Amount: 4421

AttachedGarageYN: No

PoolPrivateYN: No

Above Grade Finished Area, sq ft: 1363

Inclusions: Range, Refrigerator, Dishwasher, Microwave, Washer, Dryer, Ring Doorbell System, R/O System

Amenities

Waterfront available: No

Cooling: Central Air

Amenities: Dishwasher,Dryer,Microwave,Range,Refrigerator,Washer **Water Source:** Public

Sewer: Public Sewer

Room Sizes

Room type	Dimensions	Level
Bedroom 1	14x12	Main
Bedroom 2	12x11	Main
Bedroom 3	11x11	Main
Kitchen	10x10	Main
Living Room	12x18	Main
Dining Room	10x10	Main
Other Room	6x5	Main

Building Details

NewConstructionYN: No

Heating: Forced Air

Exterior material: Brick,Vinyl Siding

ArchitecturalStyle: Ranch

Basement: Full,Sump Pump

Parking: Attached,Garage Door Opener

Agent Details

Agent Full Name: Alex C Roup

Agent Email: alex@toddwiese.com